

Wheel Bearing Assembly, Replace

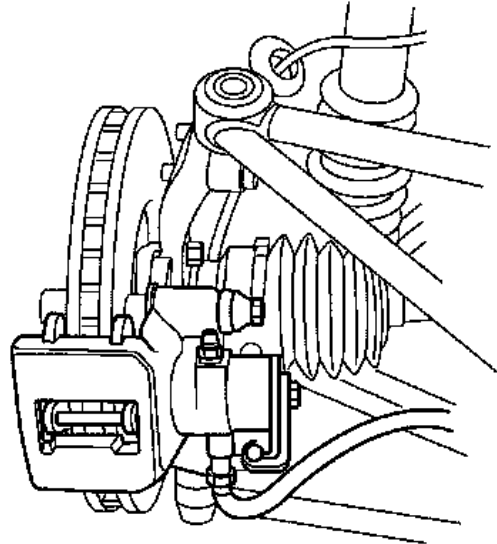

Remove

1. Remove brake pads from caliper - see "Brake Pads, Rear, Replace" in group H
2. Remove brake disc from wheel hub
 - Remove screw
3. Release brake caliper from hub carrier; position to one side, then suitably support
 - Remove top bolt



T 8772

4. Release drive shaft from wheel hub
 - Remove split pin, nut

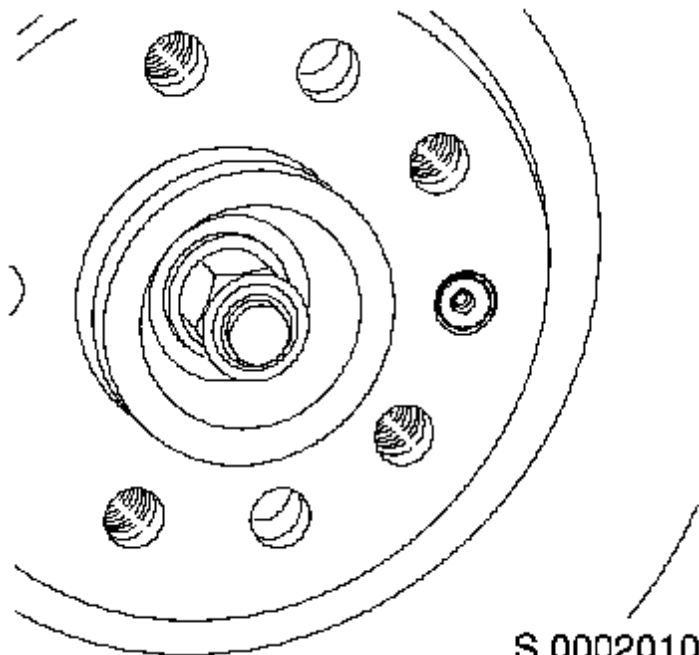

S 0002010

5. Disconnect drive shaft from wheel hub
6. Disconnect harness connector from wheel speed sensor
 - Release 2x clip
7. Remove swivel joint of lower wishbone from hub carrier
 - Remove nut

8. Remove track control arm from hub carrier
 - Remove nut, spacer, conical spacer

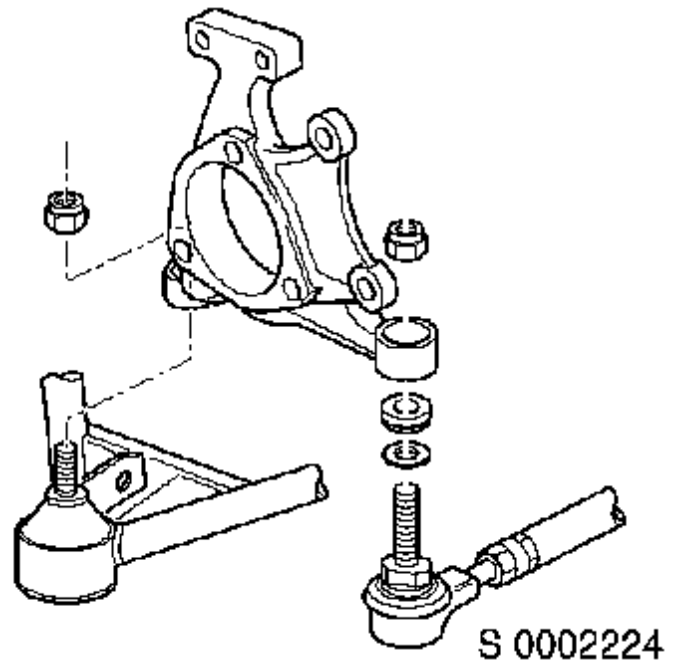

9. Remove swivel joint carrier from upper wishbone
 - Remove 2x bolt, shims (1)
 - Note:** Camber angle of wheel is controlled by shims (1); note location and number of shims

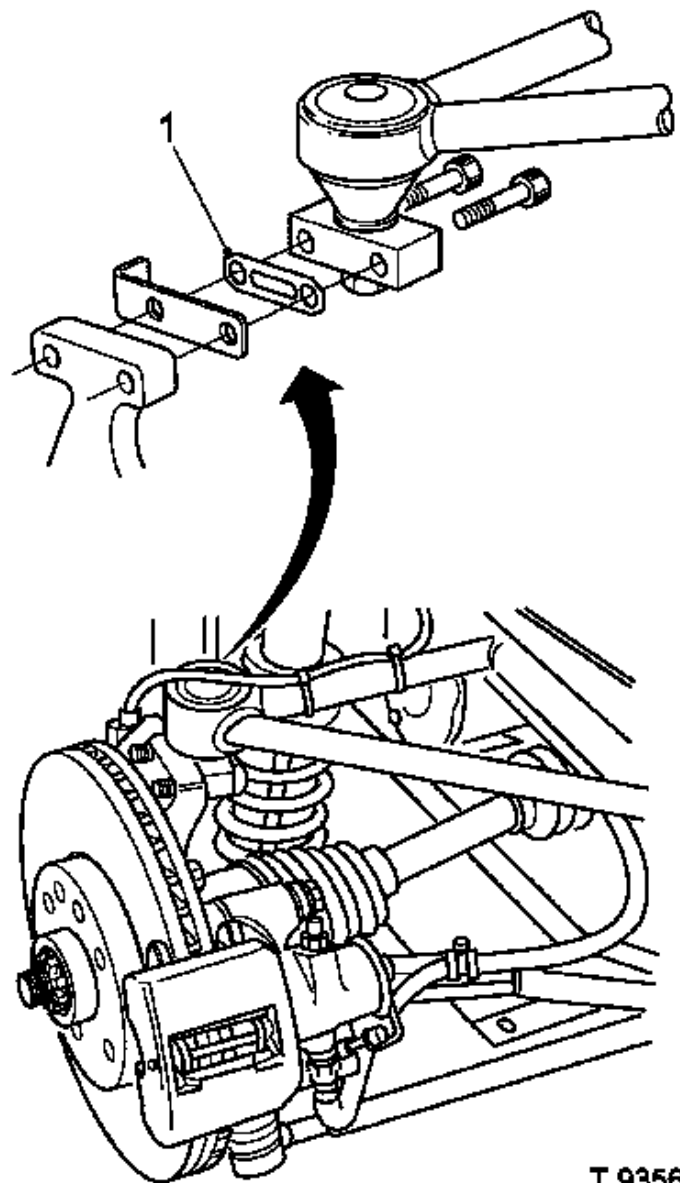

T 9356

10. Remove hub carrier and wheel bearing assembly from vehicle
11. Disassemble wheel bearing assembly from hub carrier
 - Remove 3x bolt, 3x washer

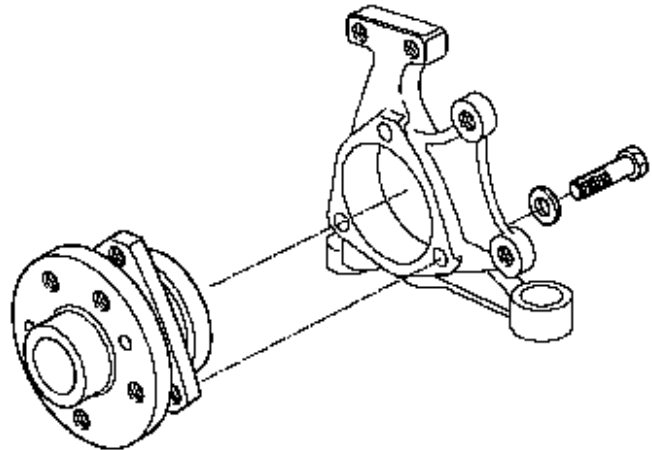

S 0002226

**Install**

12. Install wheel bearing assembly to rear hub carrier
 - Clean thread of 3x bolt and apply locking compound
 - Tighten 3x washer, 3x bolt
13. Install swivel joint carrier to hub carrier
 - Ensure that original amount of shims are installed in the position noted during removal
 - Tighten 2x bolt **45 Nm**
14. Install track control arm to hub carrier
 - Install spacer, conical spacer, new nut **45 Nm**
15. Install ball joint of lower wishbone to hub carrier
 - Install new nut **45 Nm**
16. Connect harness connector to wheel speed sensor
 - Secure 2x clip
17. Install drive shaft to wheel hub
 - Install nut **220 Nm**
 - Install new split pin
18. Install brake caliper to hub carrier
 - Install bolt **48 Nm**
19. Install brake disc to hub carrier
 - Install screw **12 Nm**
20. Install brake pads to caliper - see "Brake Pads, Rear, Replace" in group H